

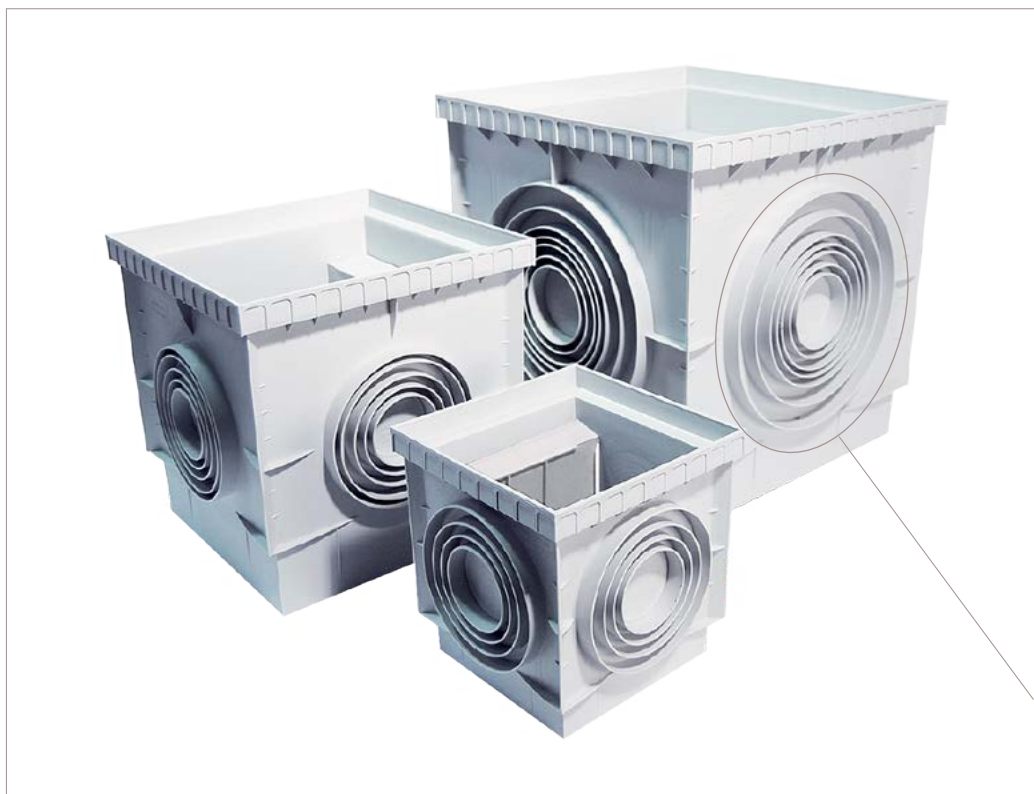





COLORI / COLORS



Plastica rinforzata e multiattacco per tubo

SCHEDA ORDINE PRODOTTO / PRODUCT ORDER DATA SHEET

COD.	MOD.*					
PS20-01	20x20	●	1	450	100x120x230	0,520 kg/pz
PS25-01	25x25	●	1	144	100x120x230	1,630 kg/pz
PS30-01	30x30	●	1	160	120x120x240	1,200 kg/pz
PS40-01	40x40	●	1	63	120x120x240	2,700 kg/pz
PS55-01	55x55	●	1	20	120x120x230	6,200 kg/pz
PS20-01V	20x20	●	1	450	100x120x230	0,520 kg/pz
PS30-01V	30x30	●	1	160	120x120x240	1,200 kg/pz
PS40-01V	40x40	●	1	63	120x120x240	2,700 kg/pz

*MEASURES IN CENTIMETERS

SCHEDA TECNICA PRODOTTO / TECHNICAL SHEET

MOD.*	A*	H*	H1*	H2*	Ingressi/Uscite**/Outlets**
20x20	19,6	20	18	10	50-63-80-100-125
25x25	24	24,9	22,4	12	63-80-100-125-140-160
30x30	29,2	29,5	27,3	14,7	63-80-100-125-140
40x40	39,4	39,4	36,8	19,6	80-100-125-140-160-200-250
55x55	54,5	52	48,4	26,6	160-200-250-315

*MEASURES IN CENTIMETERS **MEASURES IN MILLIMETERS

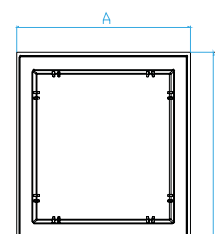
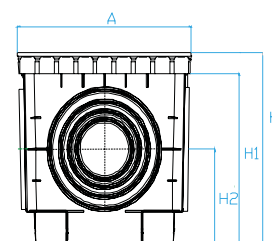

POZZETTO SINGOLO

Prodotto dal GRUPPO STAMPLAST garantisce un'ottima resistenza agli urti, agli agenti atmosferici e chimici. Il design brevettato consente di immagazzinare il 50% di articoli in più rispetto alla concorrenza razionalizzandone soprattutto il trasporto.

Materiale: Polipropilene Copolimero caricato con anti UV.

CATCH BASIN

Manufactured by GRUPPO STAMPLAST it provides excellent impact, weathering and chemicals resistance. The patented design allows you to store 50% higher quantity than competitors making transportation more convenient.

Material: Stabilized Polypropylene Copolymer with anti UV.